

0. Detalhes Gerais 1:50

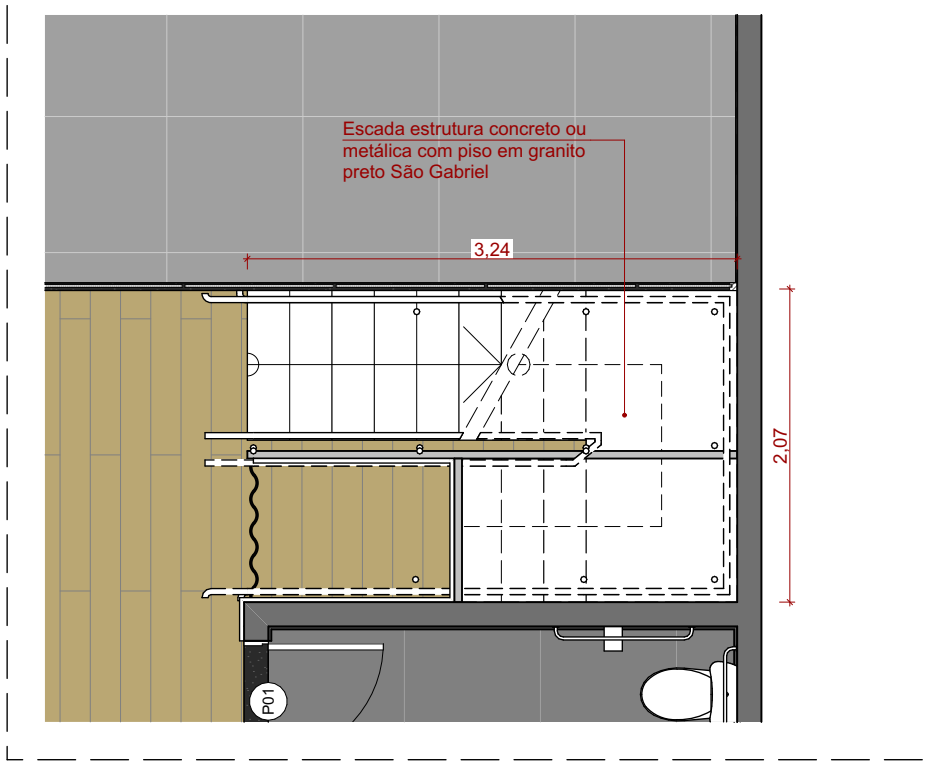

05 Detalhe 05 - Escada 1:50

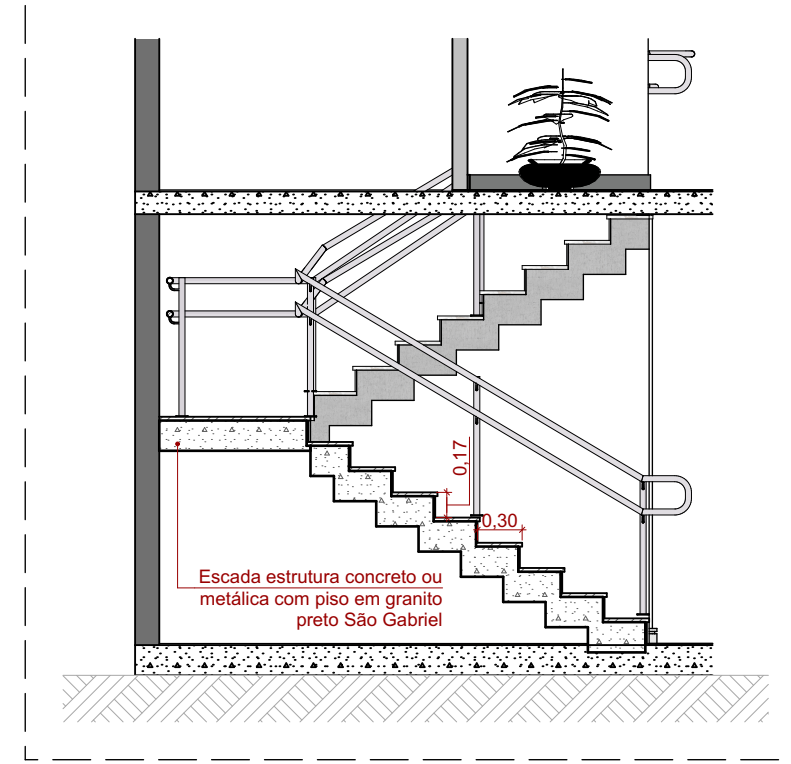

05 Corte - Det. 05 - Escada 1:50

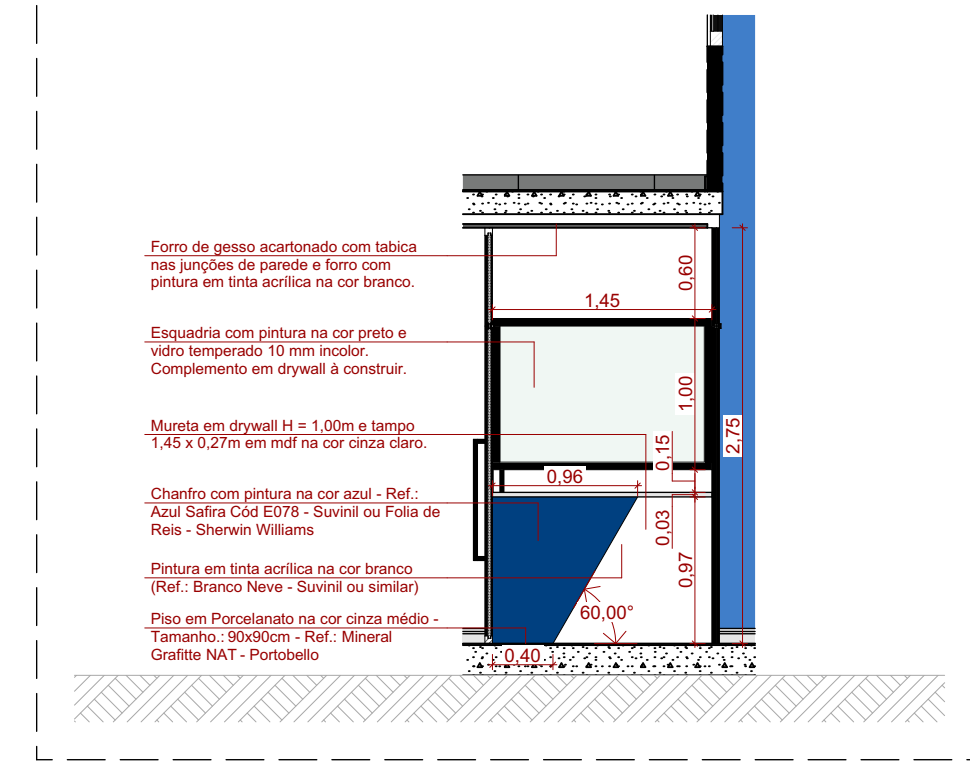

06 Vista - Det. 06 - Caixa 1:50

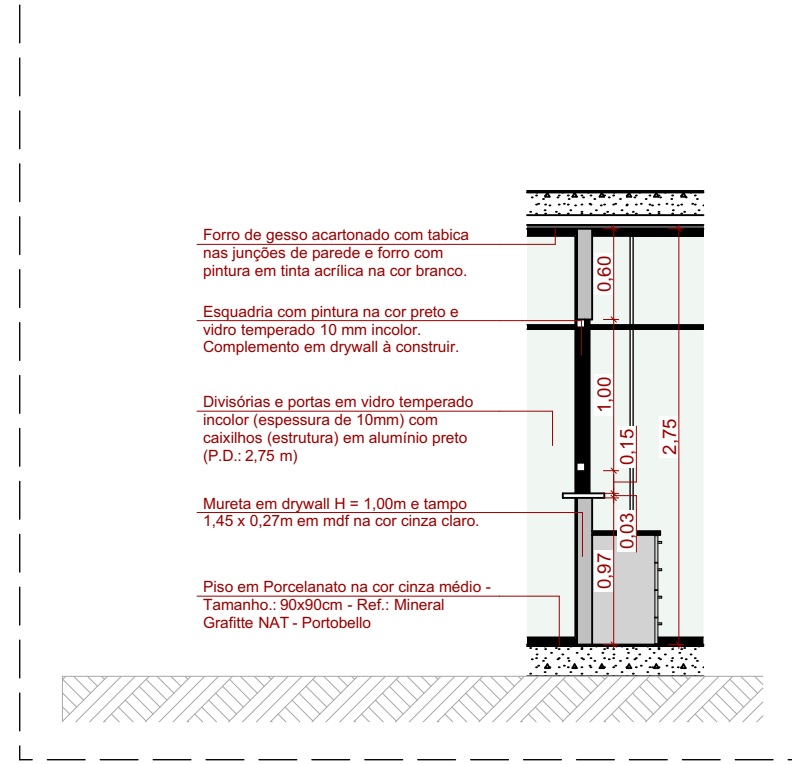

06 Corte - Det. 06 - Caixa 1:50

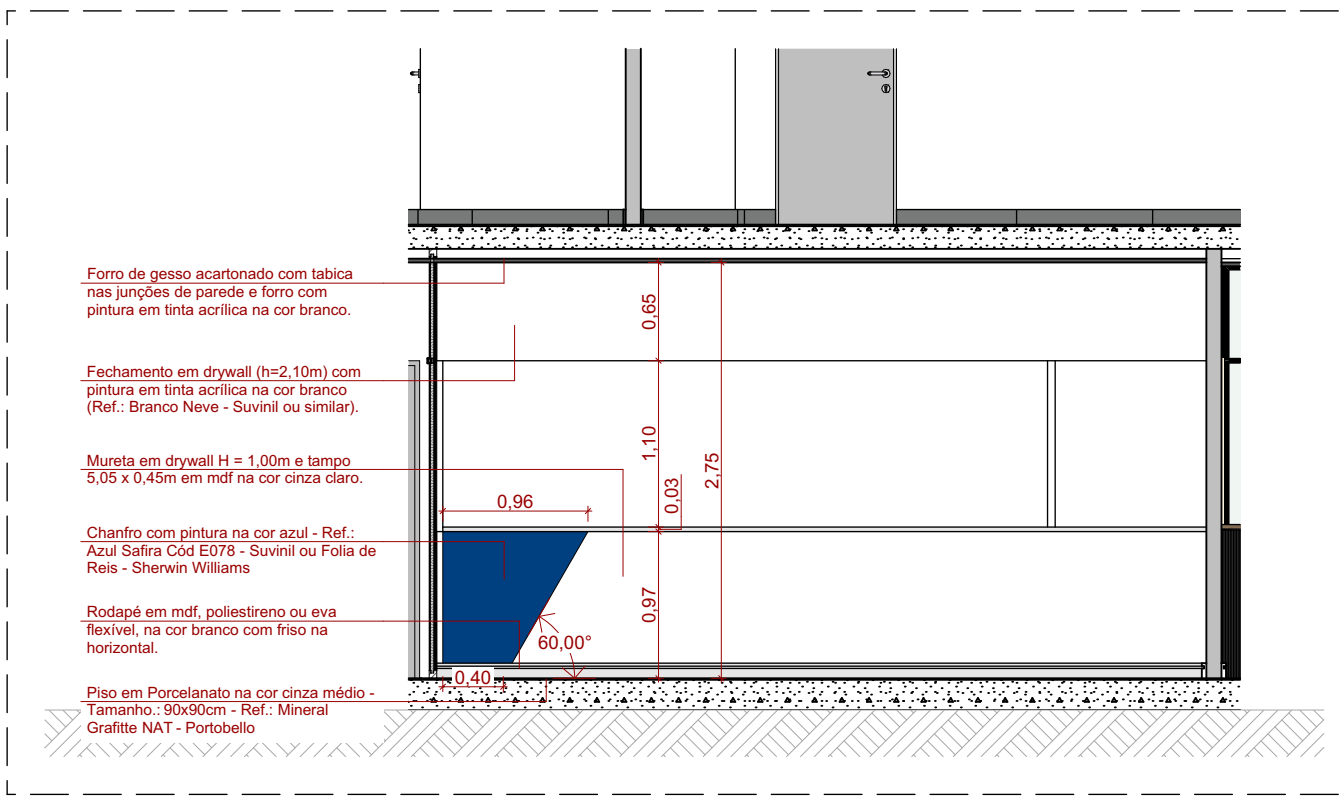

07 Vista - Det. 07 - Venda de Peças 1:50

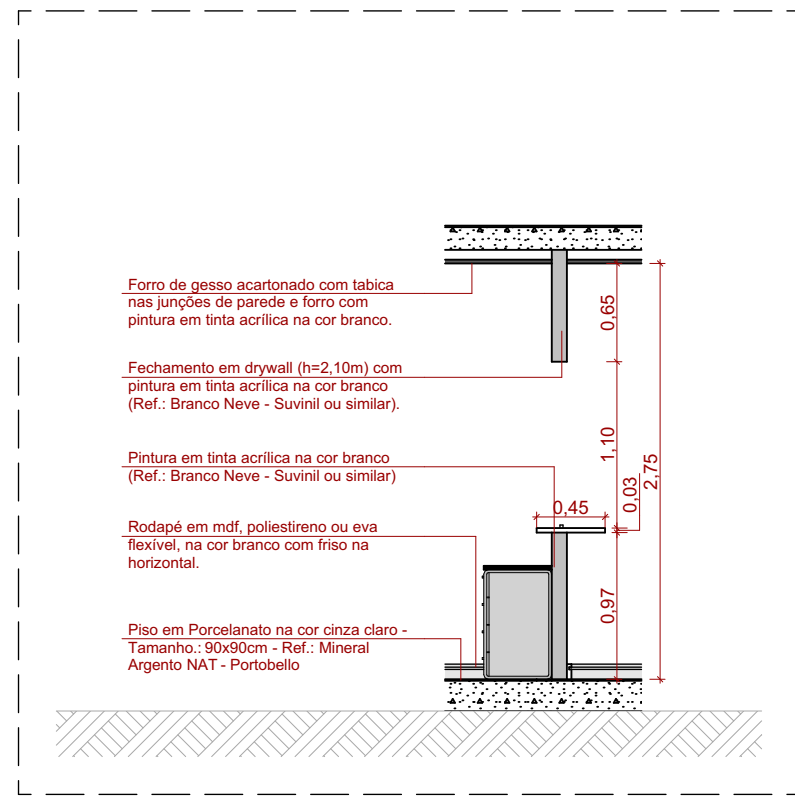

07 Corte - Det. 07 - Venda de Peças 1:50

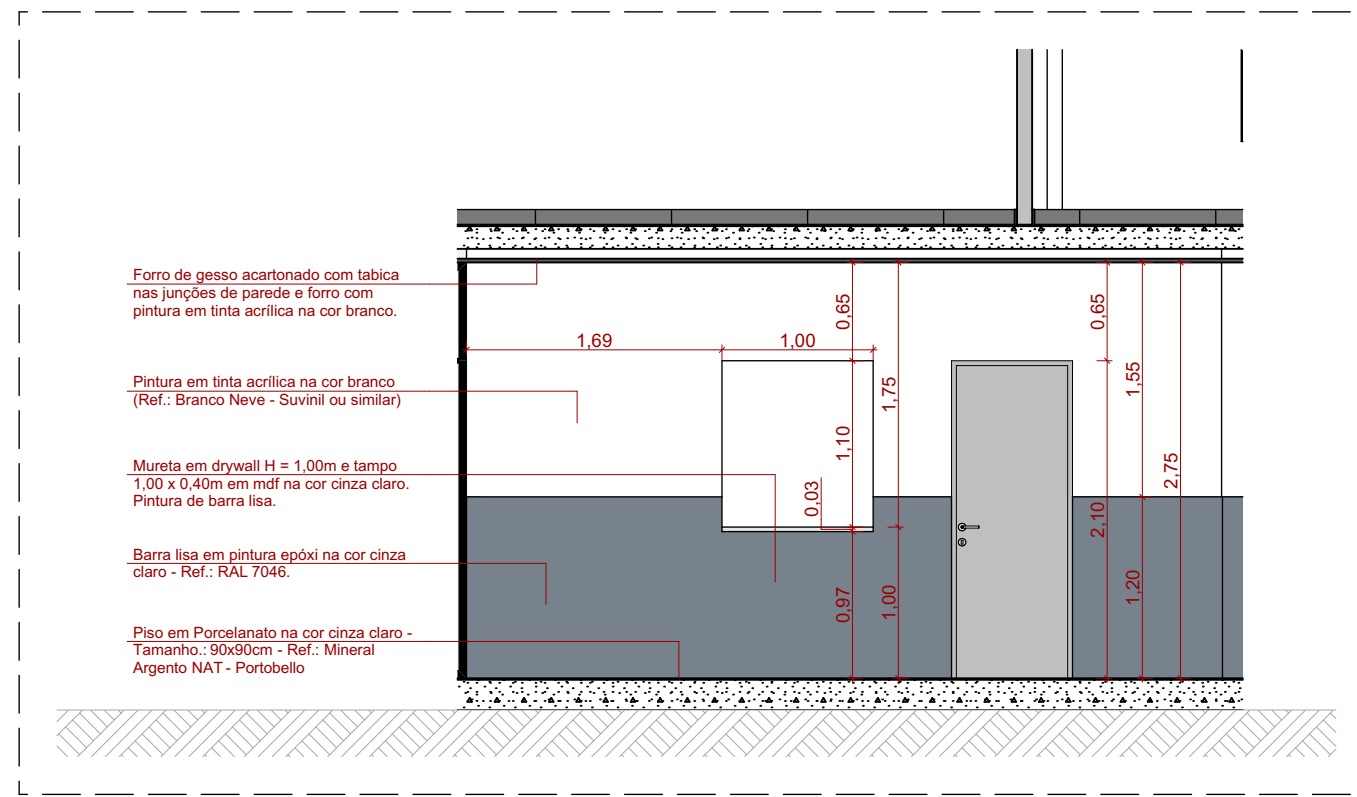

08 Vista - Det. 08 - Boqueta de Peças 1:50

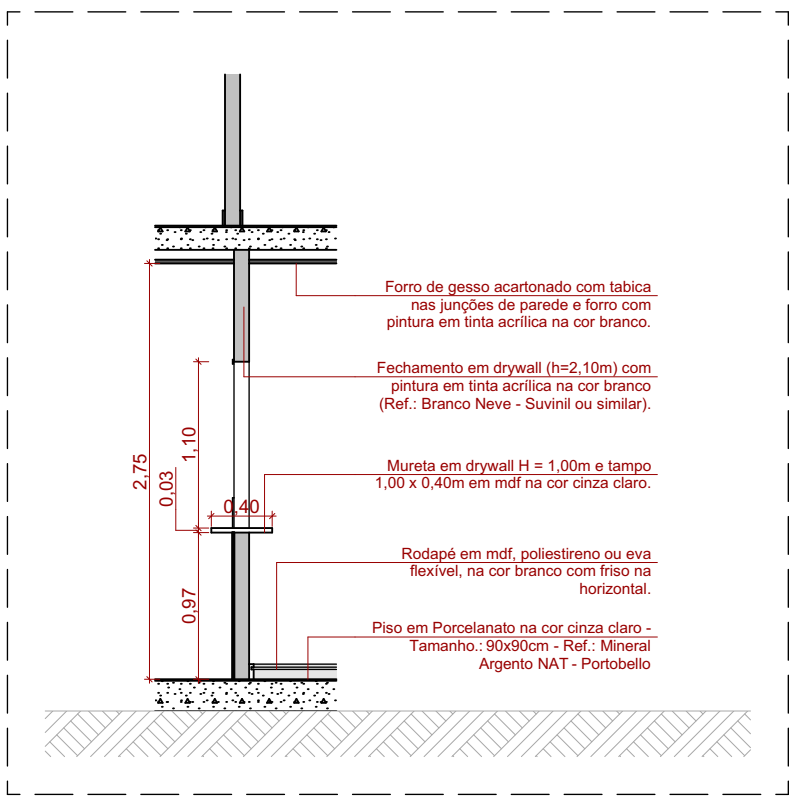

08 Corte - Det. 08 - Boqueta de Peças 1:50

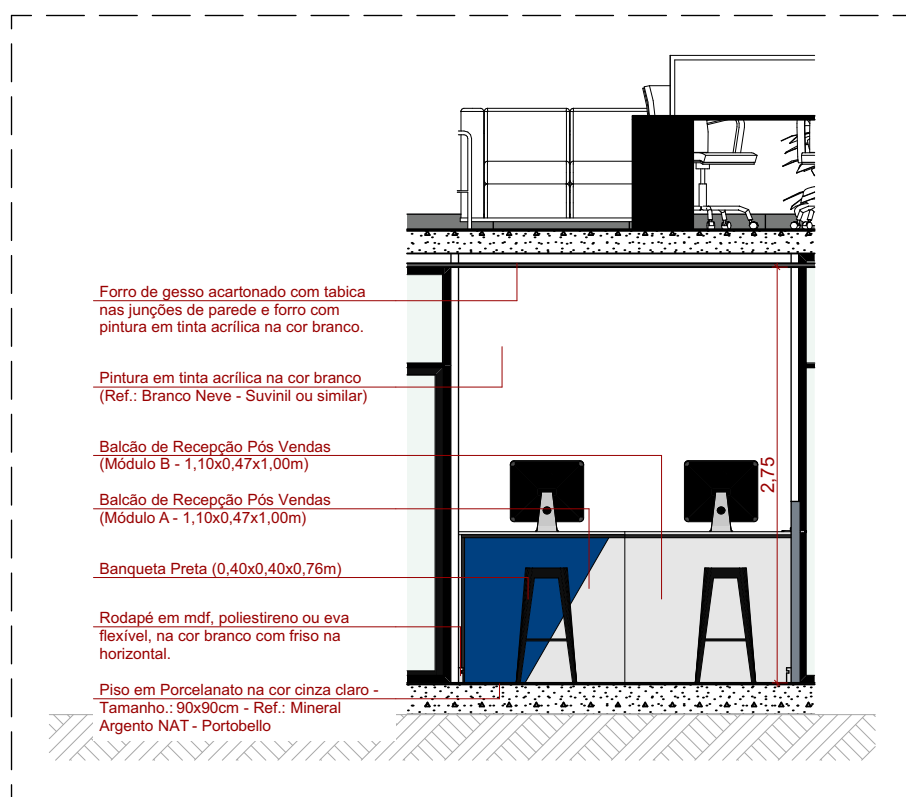

09 Vista - Det. 09 - Recepção de Serviços 1:50

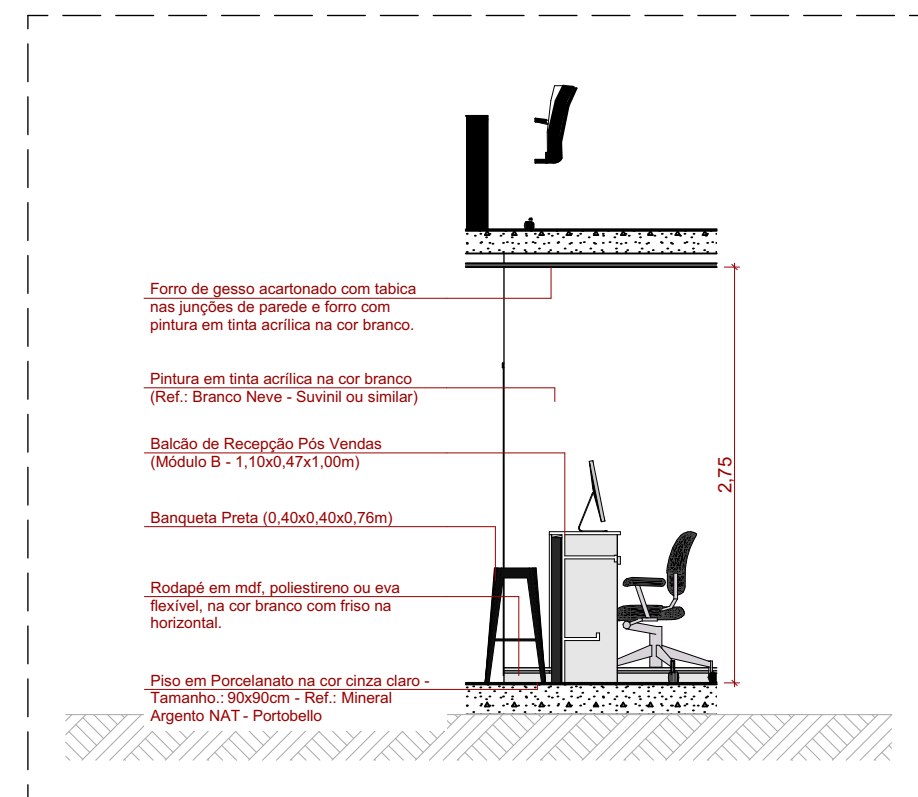

09 Corte - Det. 09 - Recepção de Serviços 1:50

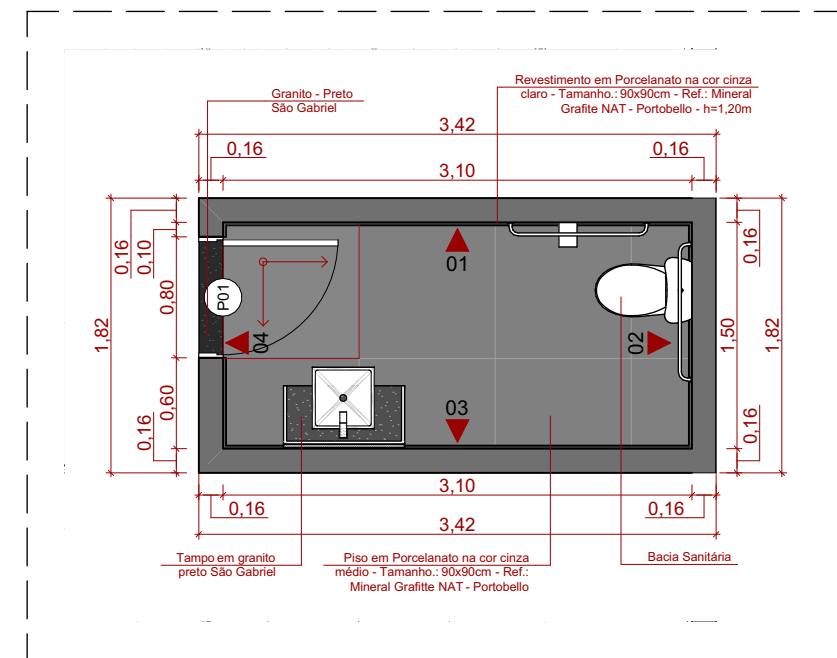

10 Detalhe 10 - W.C.PCD 1:50

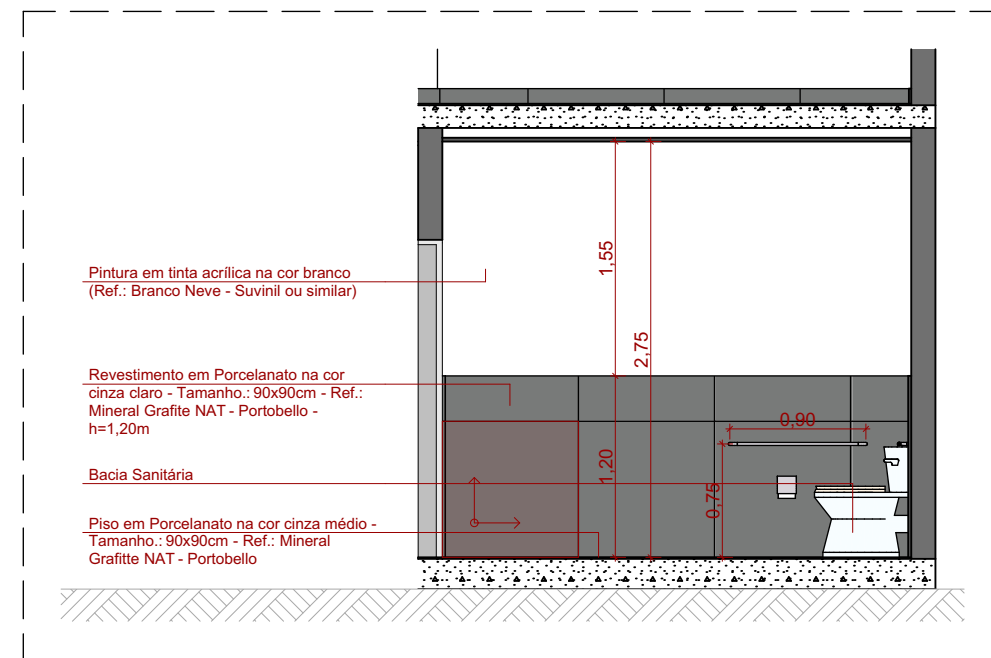

01 Vista 01 - Det. 10 - W.C.PCD 1:50

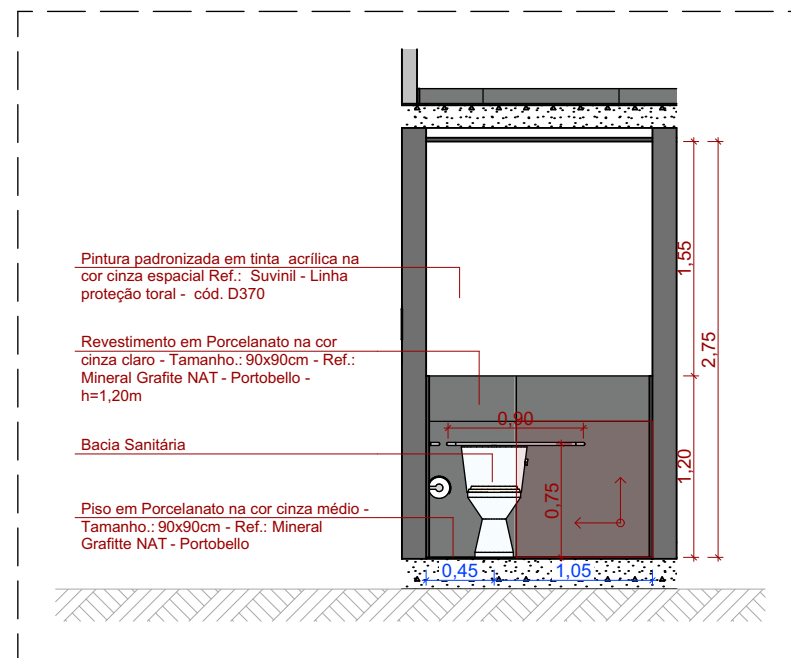

02 Vista 02 - Det. 10 - W.C.PCD 1:50

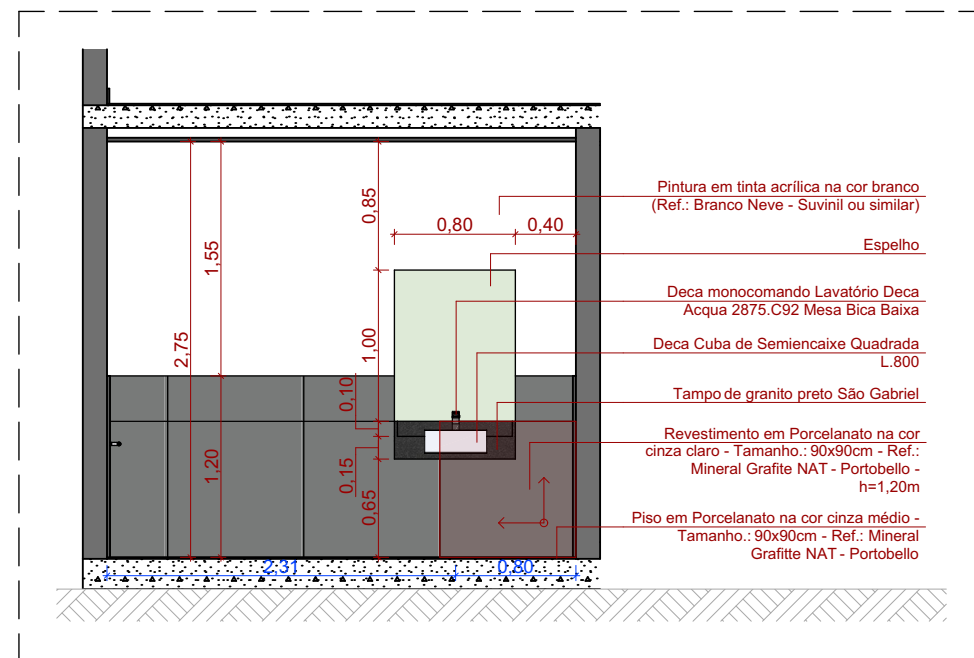

03 Vista 03 - Det. 10 - W.C.PCD 1:50

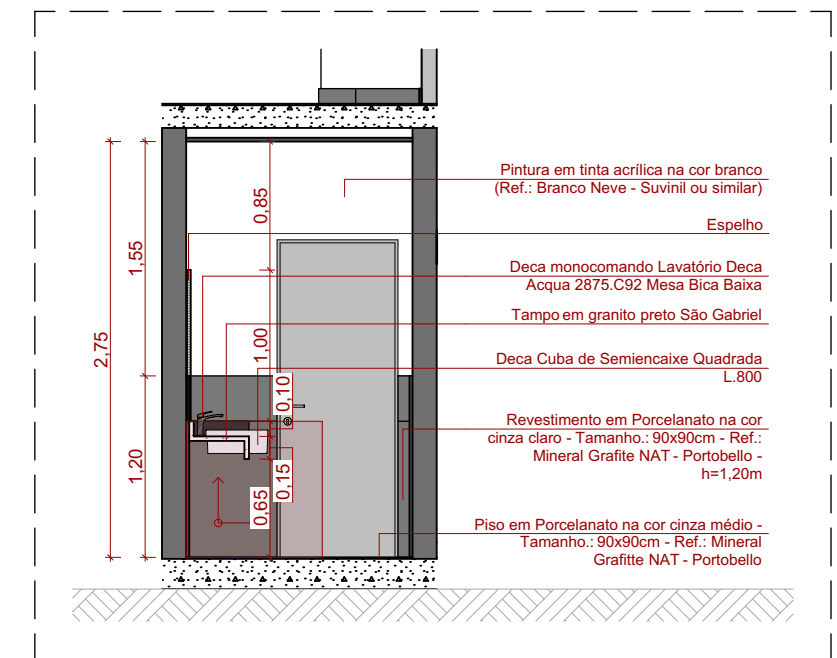

04 Vista 04 - Det. 10 - W.C.PCD 1:50

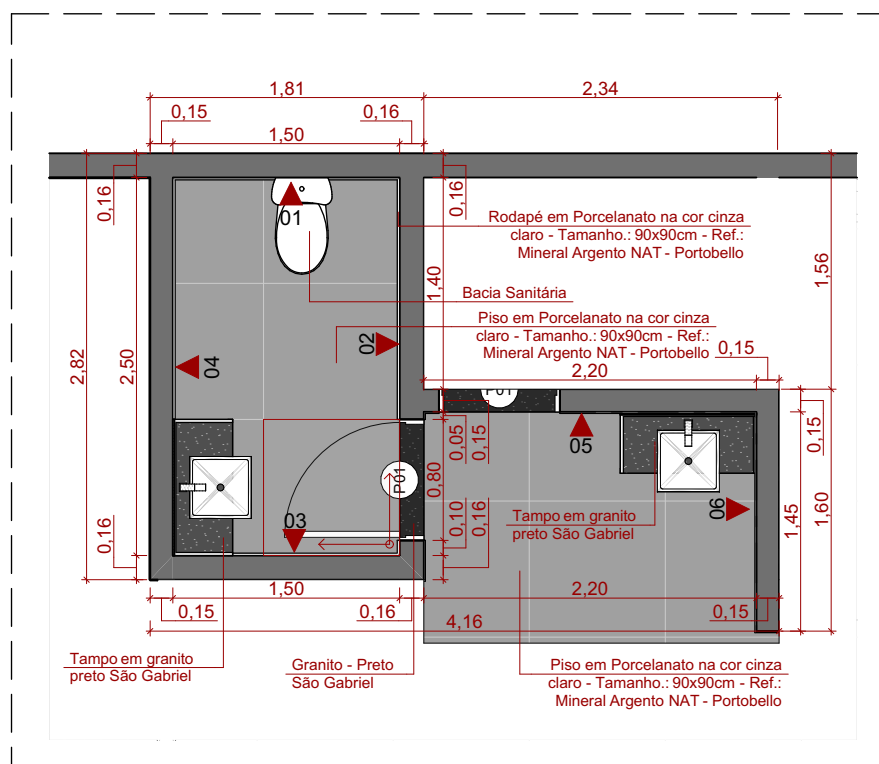

11 Detalhe 11 - W.C.M. + Lavatório 1:50

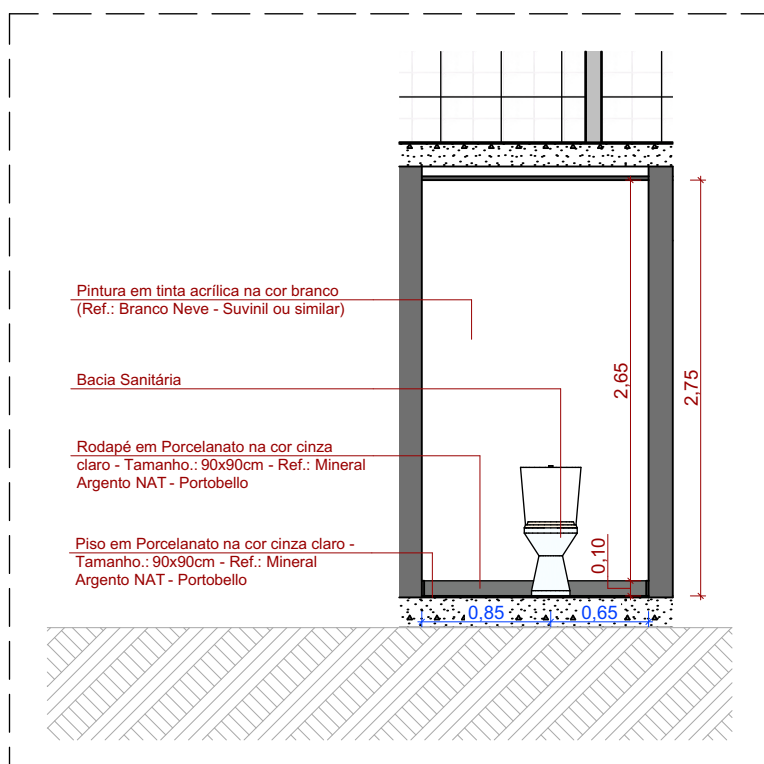

01 Vista 01 - Det. 11 - W.C.M. + Lavatório 1:50

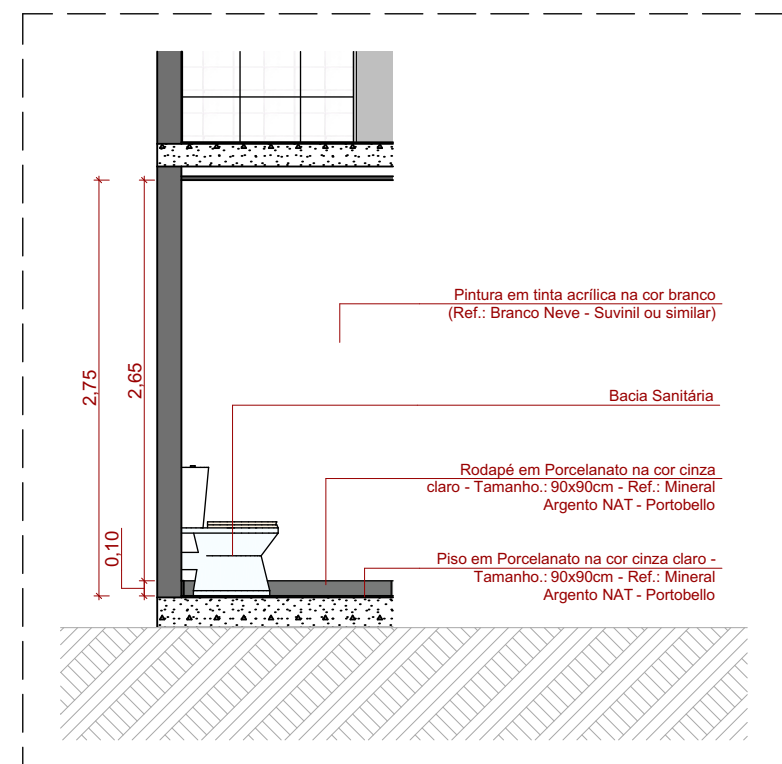

02 Vista 02 - Det. 11 - W.C.M. + Lavatório 1:50

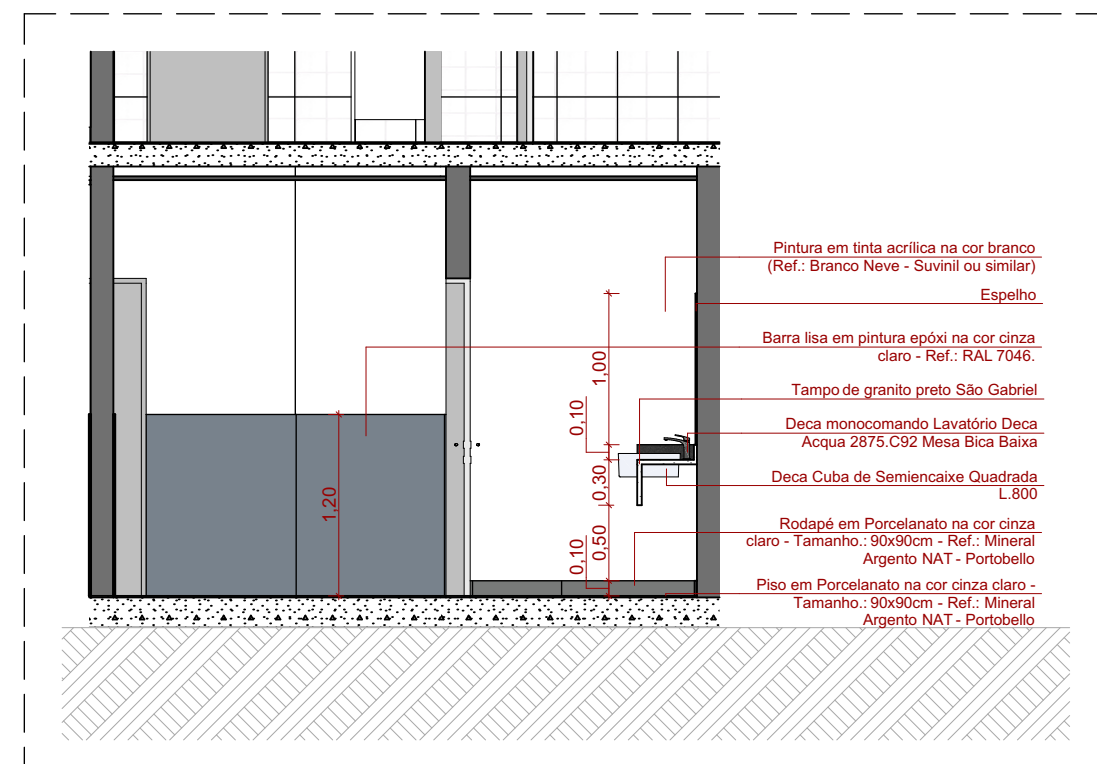

03 Vista 03 - Det. 11 - W.C.M. + Lavatório 1:50

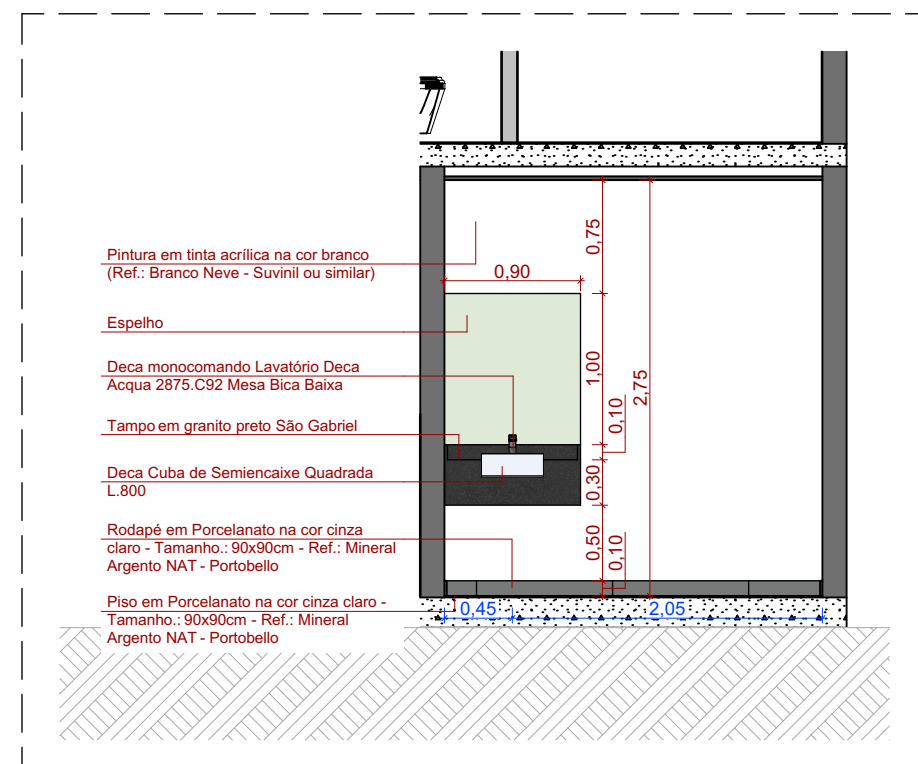

04 Vista 04 - Det. 11 - W.C.M. + Lavatório 1:50

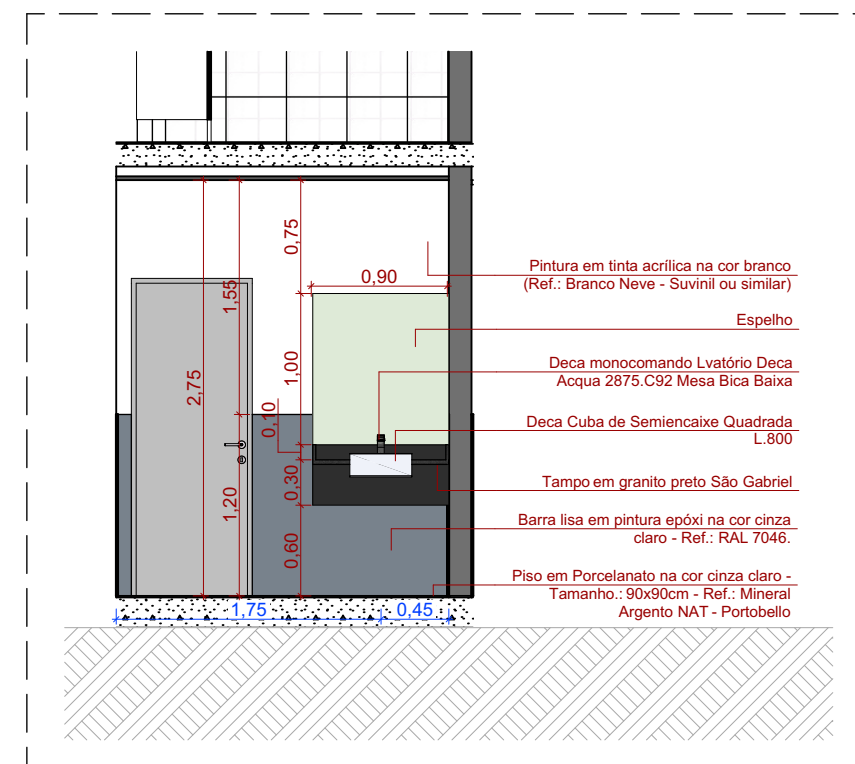

05 Vista 05 - Det. 11 - W.C.M. + Lavatório 1:50

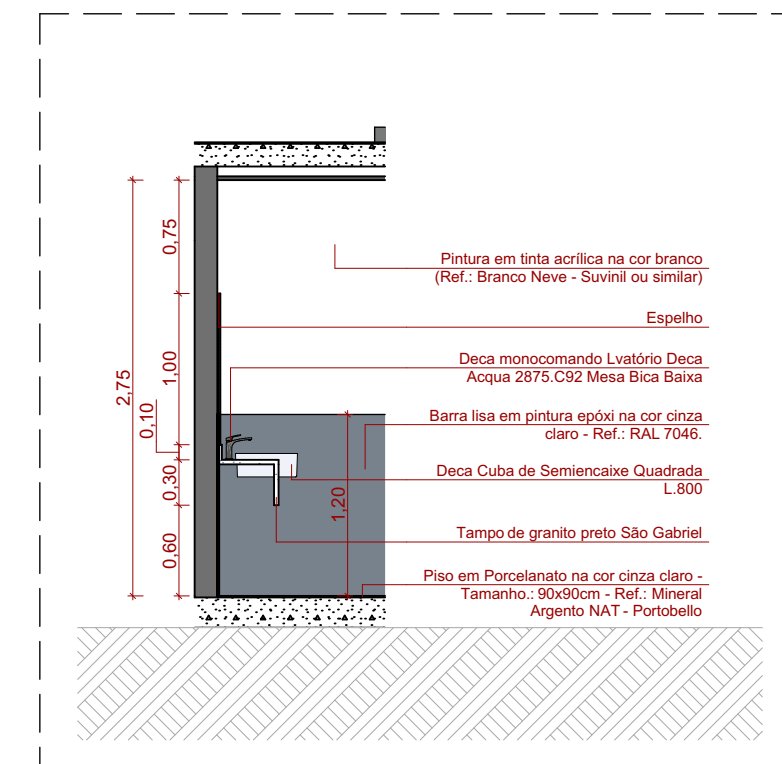

06 Vista 06 - Det. 11 - W.C.M. + Lavatório 1:50

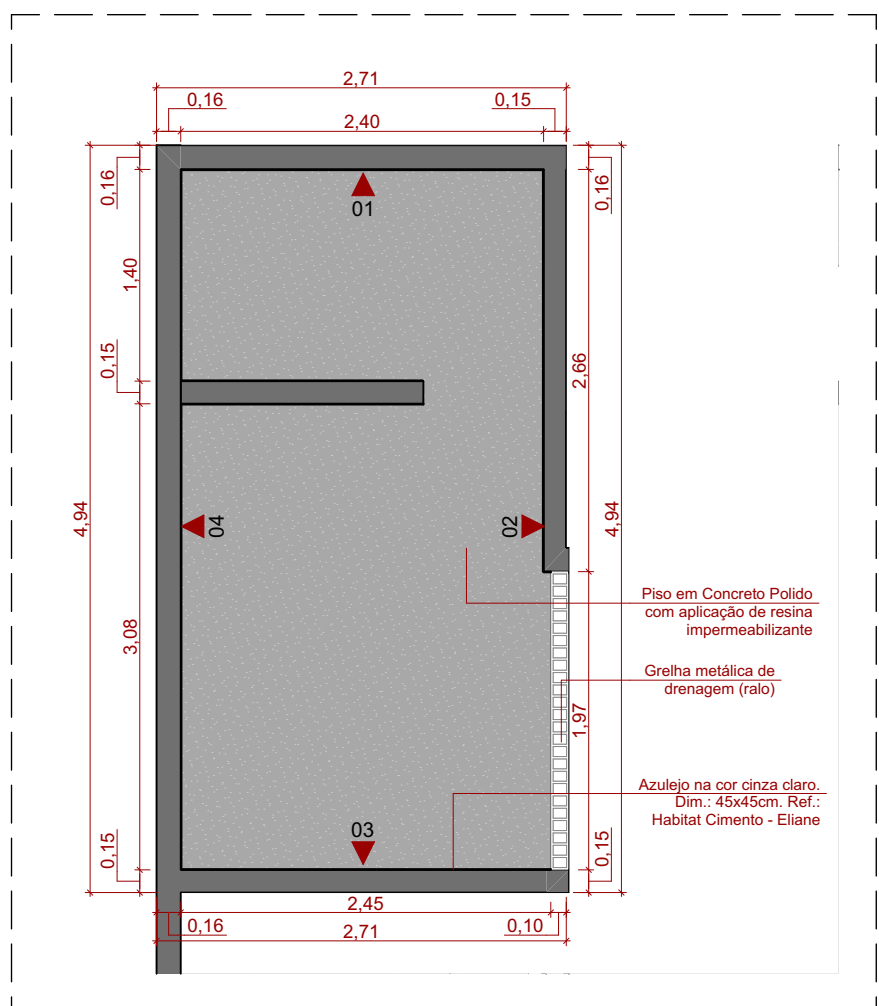

12 Detalhe 12 - Lavador 1:50

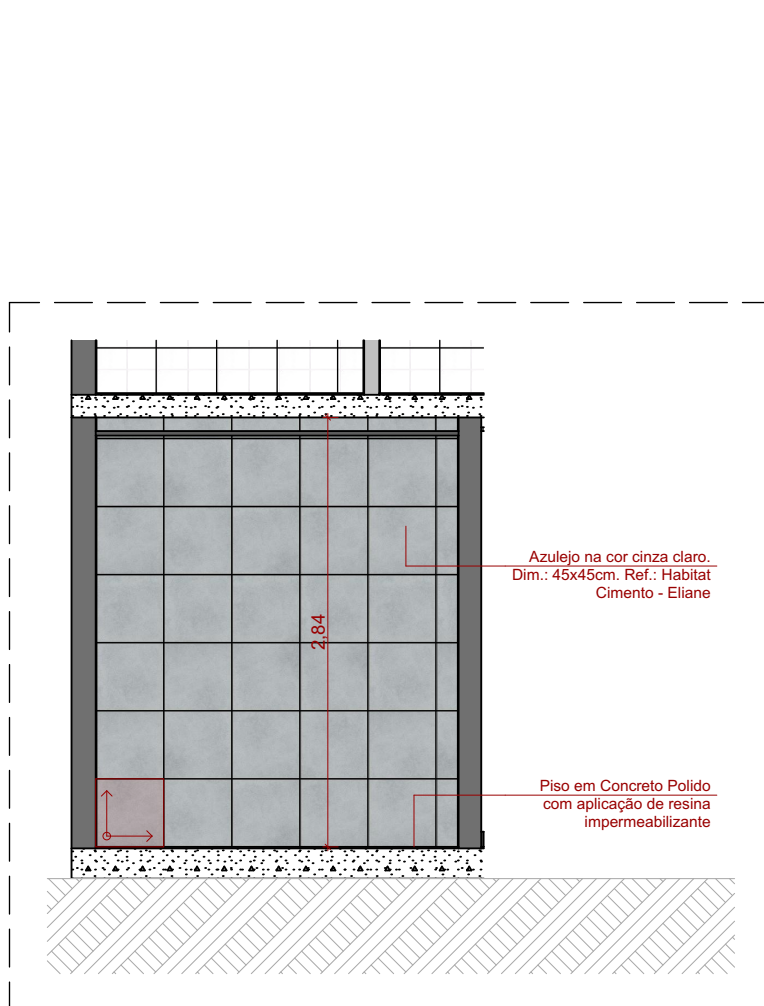

01 Vista 01 - Det. 12 - Lavador 1:50

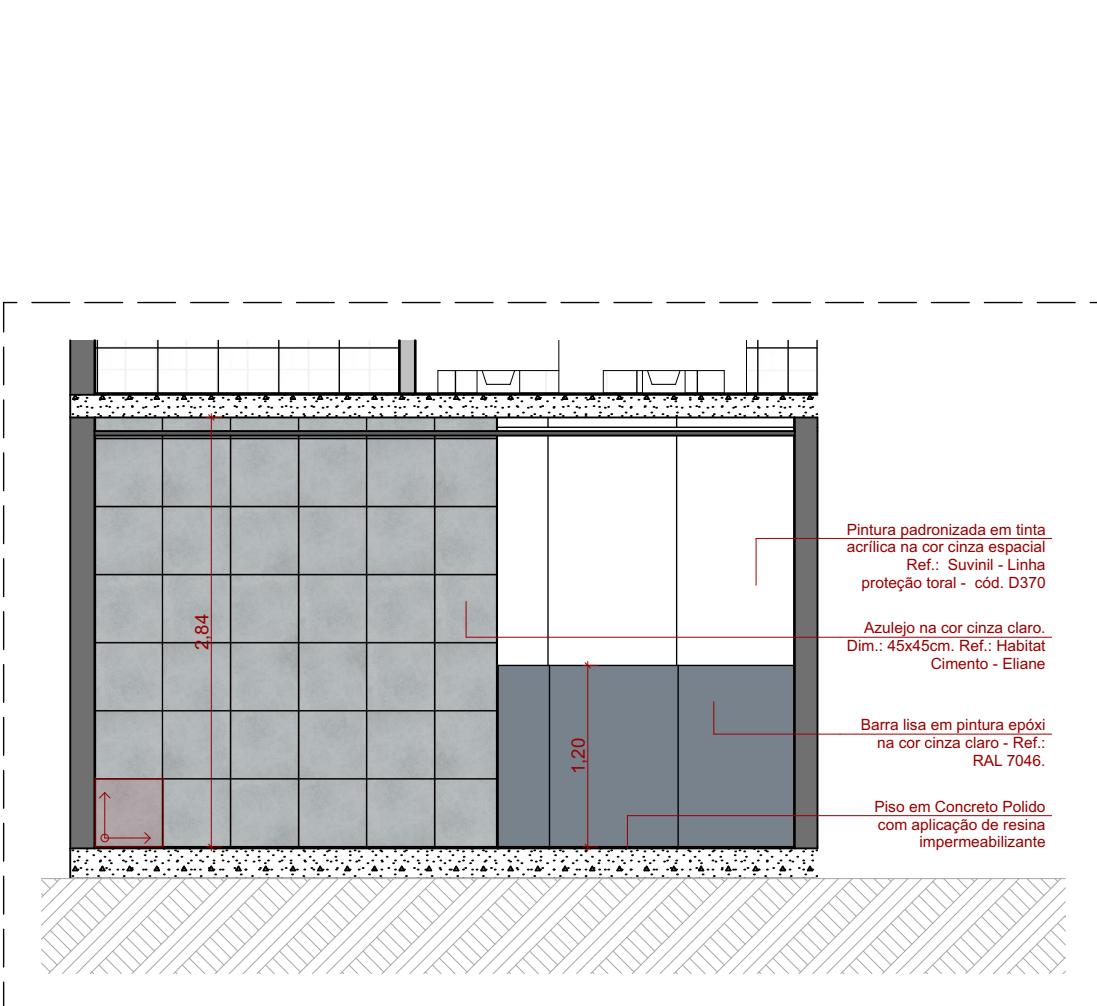

02 Vista 02 - Det. 12 - Lavador 1:50

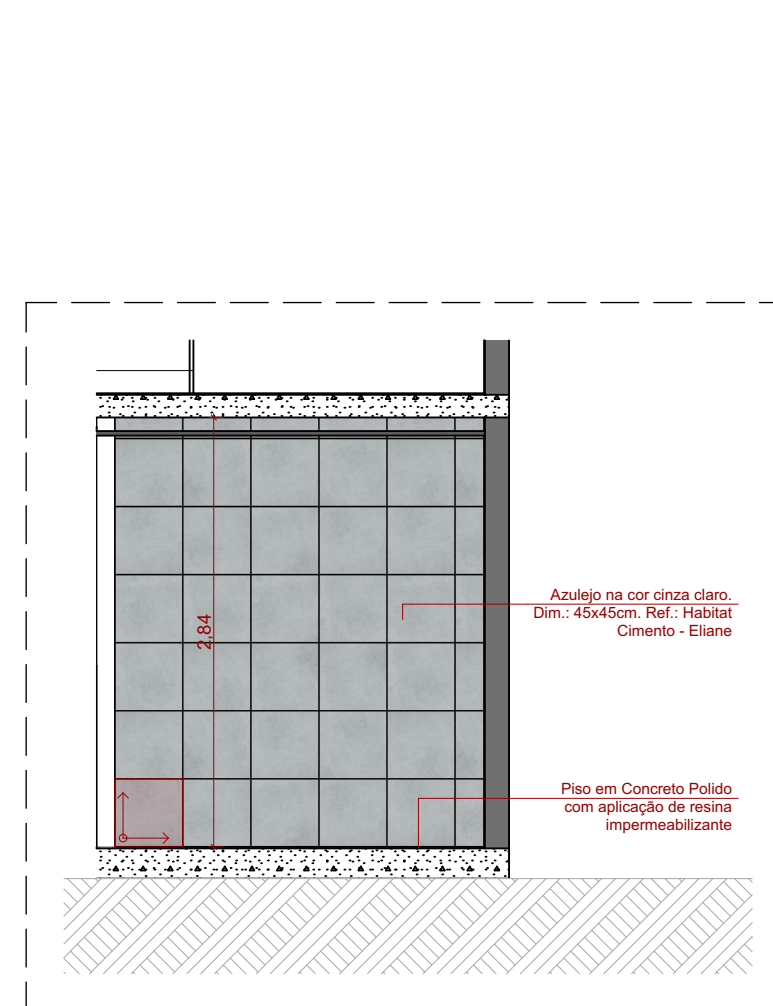

03 Vista 03 - Det. 12 - Lavador 1:50

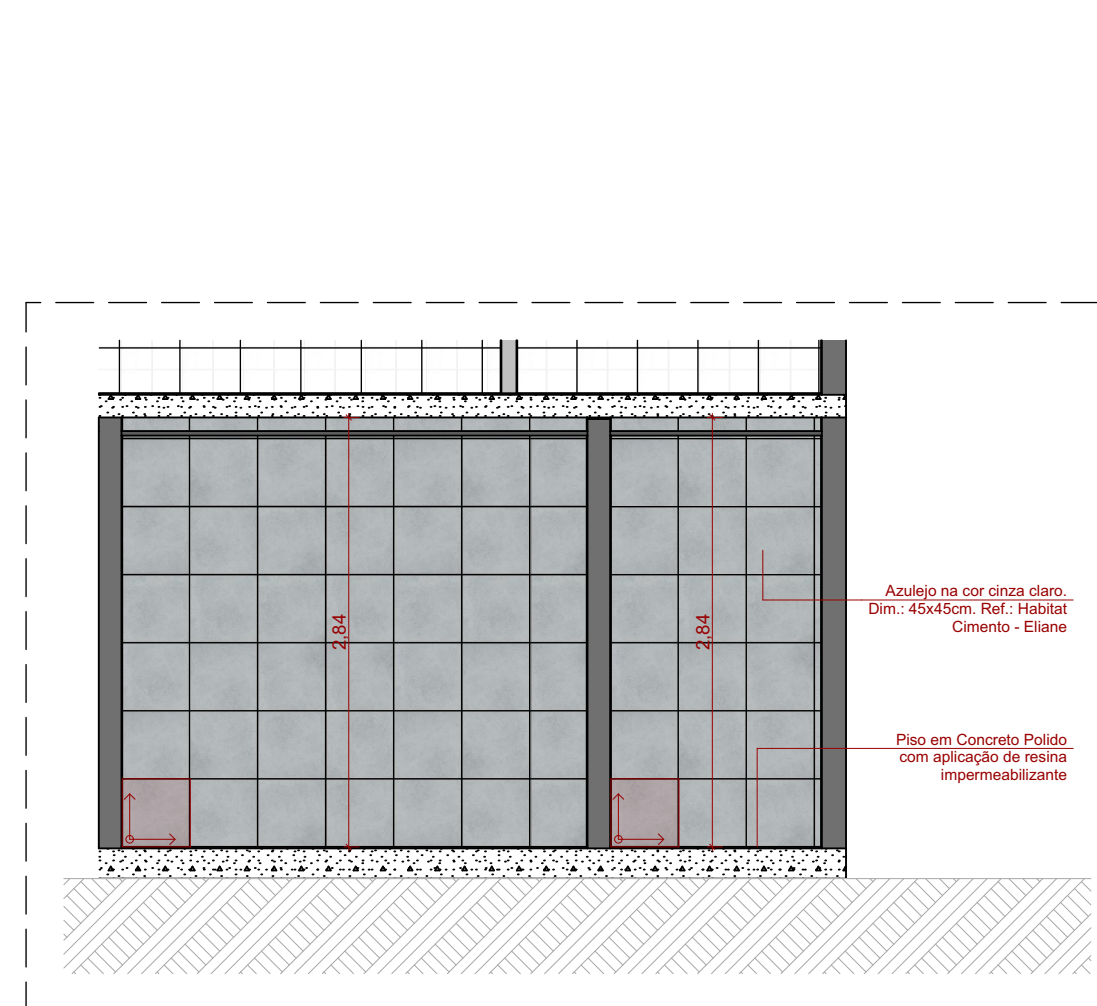

04 Vista 04 - Det. 12 - Lavador 1:50

#### NOTAS

1. Conferir medidas no local. Medidas em metros.
2. Todos os contratados e subcontratados devem verificar atentamente todos os desenhos e especificações. Todas as medidas devem ser verificadas em obra e no caso de observada qualquer divergência, deve-se informar ao responsável indicado.
3. Caso algum dos acabamentos especificados encontre-se fora de linha ou não exista estoque suficiente para o fornecimento, deve-se, imediatamente, entrar em contato com representante desta para nova especificação.
4. Dimensões escritas têm prioridade sobre dimensões verificadas com escala. Quaisquer incompatibilidades devem ser informadas para serem tornadas as devidas providências.

REVISÃO	DATA	RESPONSÁVEL	DESCRIÇÃO